

Electric Gate Lock

Installation Manual

PLEASE NOTE : Due to the various mounting applications, no mounting hardware is provided with the Electric Gate Lock. All necessary mounting hardware can be obtained from your local hardware store, all other hardware is provided.

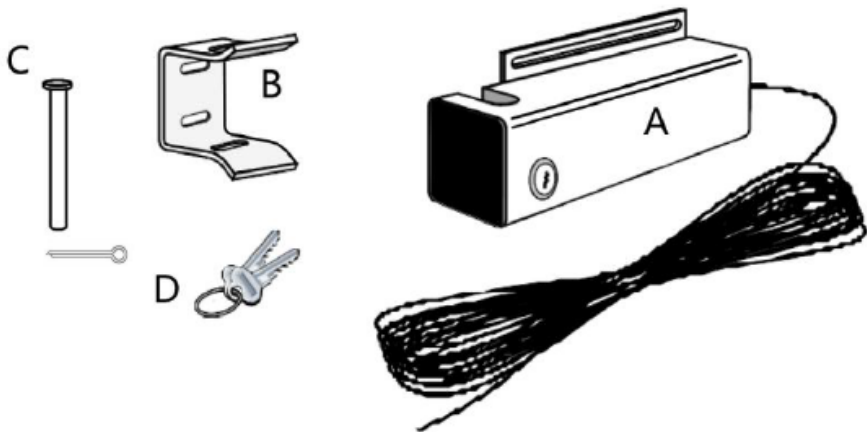

Parts

A. Lock with 6mtrs cable

B. Lock Receiver

C. Clevis Pin & Split Pin with Washer

D. Lock Keys (for manual release) *these are security keys and only suited to your gate lock. We do not hold spare keys. If you lose these keys you will need to have a locksmith replace the barrel and supply you with a new set of keys.*

Installing the Electric Gate Lock

Note: The Electric Gate Lock can be installed on a single and double gate system.

Disconnect the actuator arm from the gate to allow the gate to swing freely during installation of the gate lock.

Step 1. With the gate in the closed position, determine the best location for the lock and the lock receiver. The lock and receiver must be level and aligned with the actuator arm. Also, the lock should have a solid surface or cross member to provide stability.

Step 2. Clamp the receiver and lock together (with receiver pin hole and lock slot aligned) to the gate, mark their positions to drill the receiver bolts. The receiver must be mounted with carriage bolts, no U'bolts, to allow the lock to seat properly.

Step 3. Recheck the lock's position and alignment, then mark it's position for drilling the holes. Drill the hole gate supports through the slots in the lock bracket. U-bolts and saddles can be used to mount on chain link gate supports. Secure the lock to the gate. Install clevis pin by placing pin through the slot in the lock receiver, insert washer and split lock pin, secure the lock bracket and check the alignment again.

For wiring diagrams please scan the QR code below.

Please note our diagrams are only for BMGi gate automation. If you are using this gate lock on any other sysetm you will need to refer to your original gate installation manual.



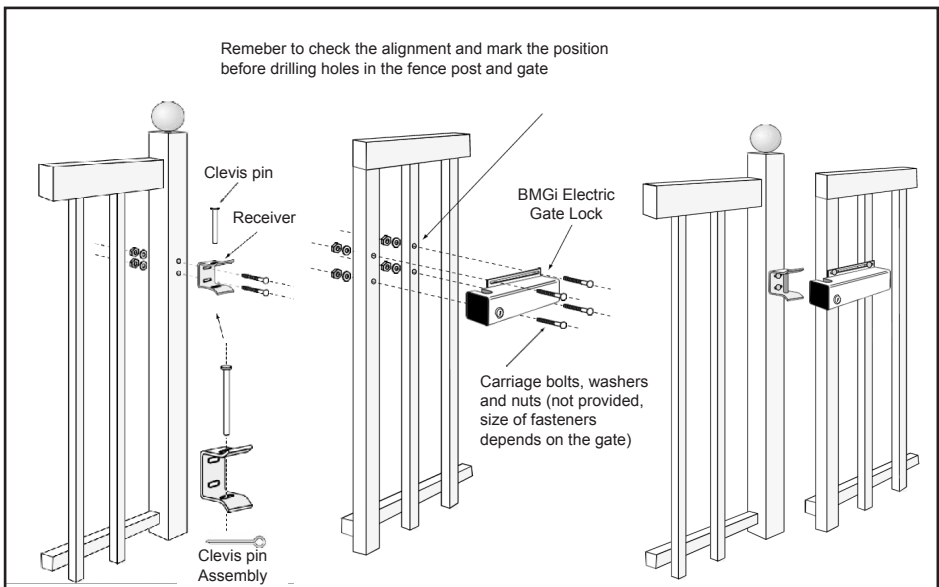
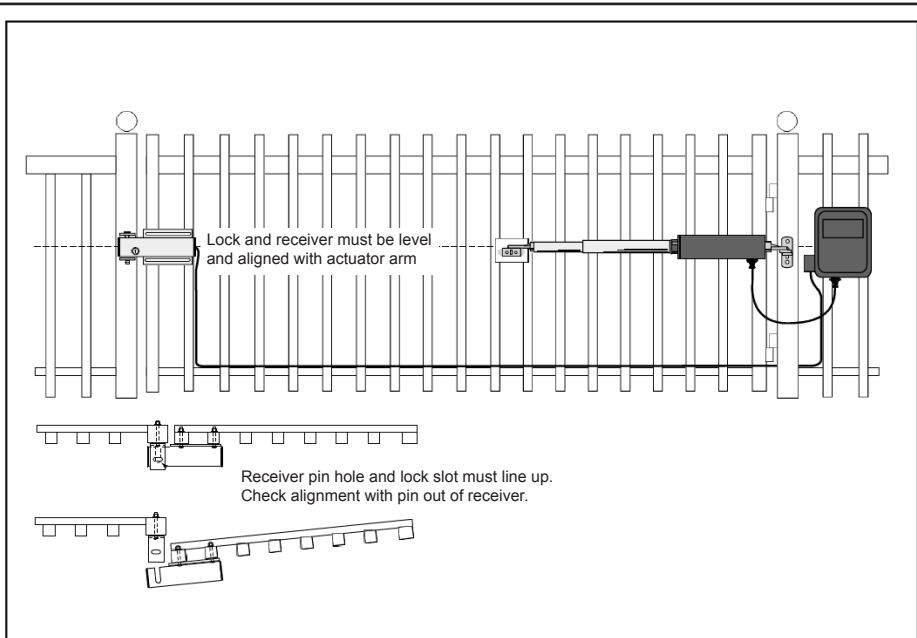

Maintenance:

- * Regularly check that the gate lock and receiver are aligned correctly.